

ECO	DATE	SYM	REVISION RECORD	DR	CK
09503	6/19/09	0	FIRST ISSUE	PF	BJ

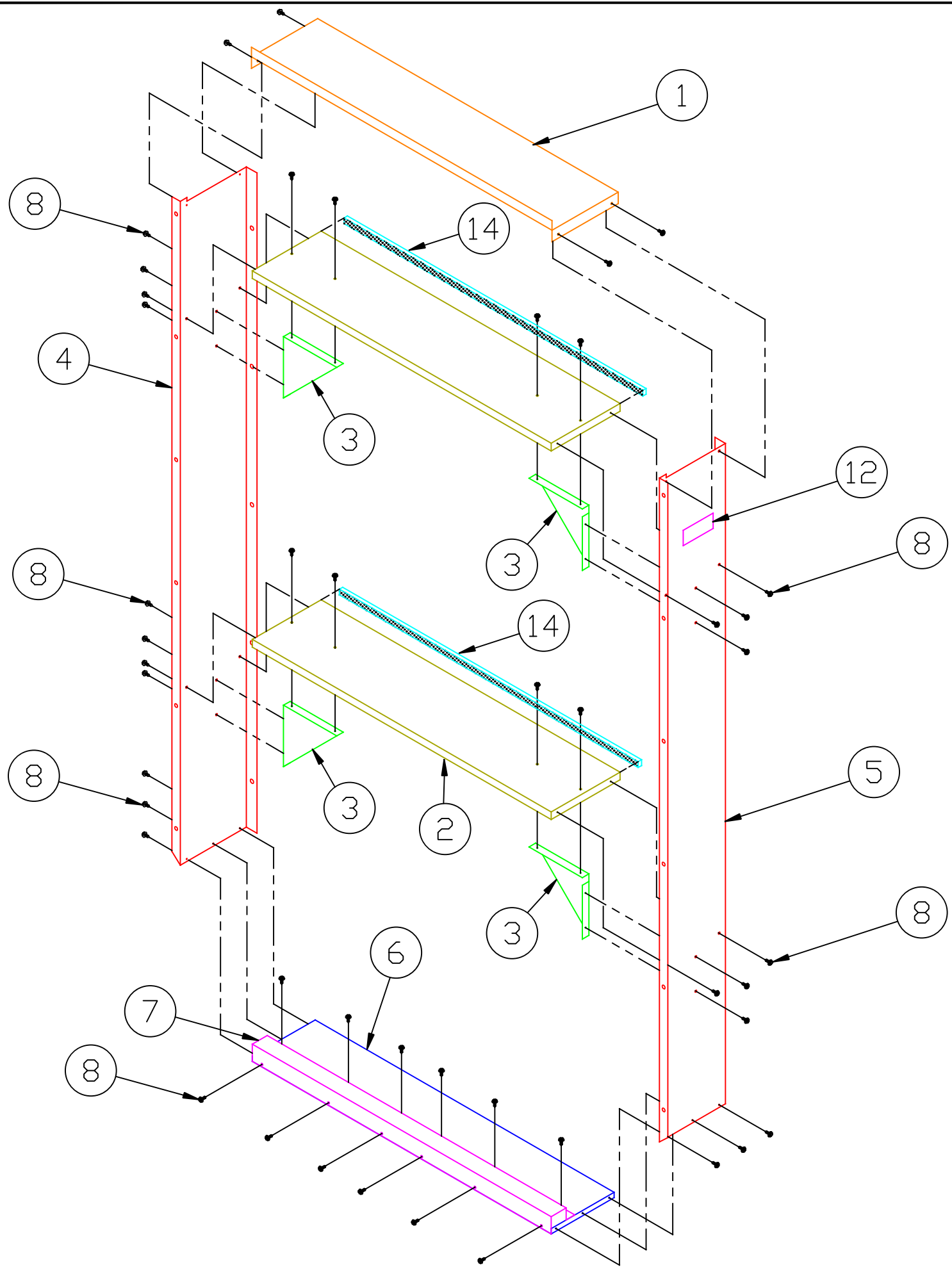

ITEM	PART No.	DESCRIPTION	QTY
1	MD/06940	TOP PANEL	1
2	MD/06942	DIVIDER PLATE	2
3	MD/04507	GUSSET	4
4	MD/06945	RH SIDE PANEL	1
5	MD/06944	LH SIDE PANEL	1
6	MD/06941	BOTTOM PANEL	1
7	MD/06943	BASE STIFFENER	1
8	90740	SCREW-#10 X 1/2" SERR. HX HD.SLTD.	48
9	90955	7/16-14X1 LG HEX HD BOLT	10
10	90956	7/16-14 NYLOCK HEX NUT	10
11	90957	7/16-14 FLAT WASHER	20
12	LA/01074	ELECTRIC HEAT LABEL	1
13	90458	#10 TEKS SCREW	3
14	NB/01592	1/2 X 3/4 FOAM INSULATION	2
15	ID/01431	INSTALLATION INSTRUCTIONS	1
16	ID/01430	ASSEMBLY INSTRUCTIONS	1

This drawing contains confidential information of Marvair, a Division of AIRXCEL, Inc. This information is not to be disclosed or utilized without the expressed written permission of Marvair, a Division of AIRXCEL, Inc.

TOLERANCES EXCEPT AS NOTED

DECIMAL	WMA 30/36	SCALE	NTS	DRAWN BY	PF
FRACTIONAL		TITLE	ASSEMBLY INSTRUCTIONS		
ANGULAR	DATE	DRAWING NUMBER	REV.		
±	6/19/09	ID/01430	3		

Marvair Division of AIRXCEL, Inc. Cordele, GA